

TRICO Plastic Opto-Matic Oilers

Read Instructions Before Installing

1. Prior to installing the Opto-Matic Oiler, shaft rotation direction must be determined, typically indicated by an arrow on the casting of the equipment. Install oiler on the side of the equipment facing the direction of shaft rotation to prevent misfeeding of the oiler (Fig 1).
2. Determine proper oil level, which may be indicated on the equipment with an arrow. If that is not the case, engineering drawings or the equipment's operator manual can provide the information. Indicate proper oil level on equipment using a marking device such as; a marker, scribe, paint, etc.
3. Loosen set screws on reservoir assembly. Remove reservoir assembly from lower casting.
4. Be sure all connecting hardware is free from contaminants (burrs, chips, dirt, etc.) to prevent clogging or damage to the equipment to be lubricated.
5. Connect lower casting to bearing chamber either through the side connection, Type E and EH oilers (Fig. 2) or the bottom connection, Type EB and EHB oilers (Fig. 3). Use thread compound on threaded areas.
6. Verify the lower casting is level and parallel with desired oil level (Fig. 2 and 3). Make necessary adjustments if needed until lower casting is level.
7. From the oil level mark indicated on the equipment, use a level to put a mark on the outside of the Opto-Matic lower casting to indicate where the oil level should be (Fig 4).
8. Measure the distance between Opto-Matic Oiler casting edge and top edge of spout angle (Fig 5). Mark this distance above the original line made in step 7 on the outside of the Opto-Matic lower casting (Fig. 6). Now the bottom of the reservoir assembly can be used as an indicator of oil level.
9. Fill the equipment bearing chamber through the lower casting until the oil level reaches just below the mark made in step 7 on the lower casting. DO NOT fill at or above this mark as it will cause your equipment to have a high oil level.
10. Use a funnel to fill the reservoir assembly 2/3rds with the recommended oil.
11. Place thumb over reservoir spout, invert, and insert on lower casting assembly at the point where the bottom edge of the reservoir assembly is at the level "X" mark from step 8. Quickly tighten set screws on the side of the reservoir assembly.
12. Start up equipment to verify proper oil level is being maintained.

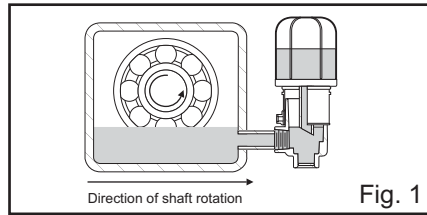

Fig. 1

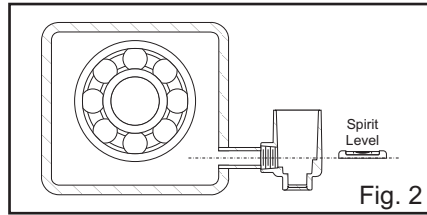

Fig. 2

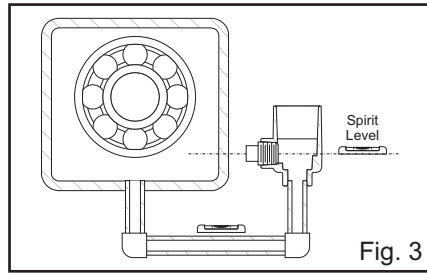

Fig. 3

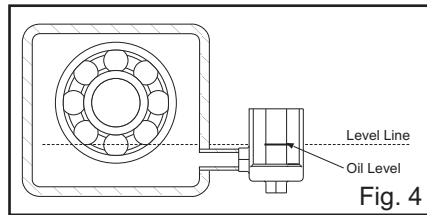

Fig. 4

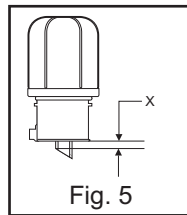

Fig. 5

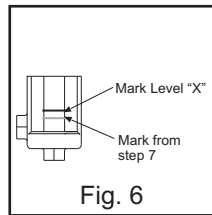
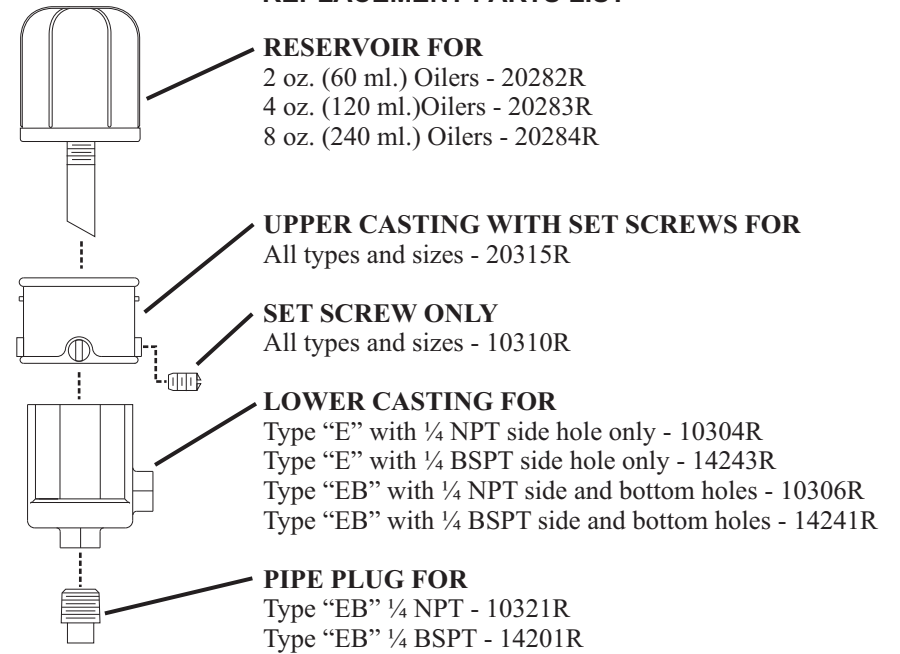

Fig. 6

"E" & EB" OPTO-MATIC REPLACEMENT PARTS LIST



"EH" & EHB" OPTO-MATIC REPLACEMENT PARTS LIST

